

Qty: 2 Ref:		Qty: 1 Ref: S73 Direction to hazard right	
Qty: 1 Ref: 13.9 Schedule 13.9: Temporary Information		Qty: 5 Ref: S73 Direction to hazard left	
Qty: 1 Ref: 2702 Start of temporary diversion route		Qty: 7 Ref: 7001 Road works ahead	
Qty: 2 Ref: 2702 End of temporary diversion route		Qty: 8 Ref: 7010-FP-13.9 Nature of temporary hazard ahead - Road Ahead Closed	
Qty: 5 Ref: 2702 Start of temporary diversion route		Qty: 2 Ref: 7010-FP-13.9 Nature of temporary hazard ahead - Road Closed	
Qty: 3 Ref: 2703 Direction of temporary diversion route from junction ahead			
Qty: 3 Ref: 2703 Direction of temporary diversion route from junction ahead			
Qty: 5 Ref: 2703 Direction of temporary diversion route from junction ahead			
Qty: 5 Ref: 2704 Direction of temporary diversion route			
Qty: 5 Ref: 2704 Direction of temporary diversion route			

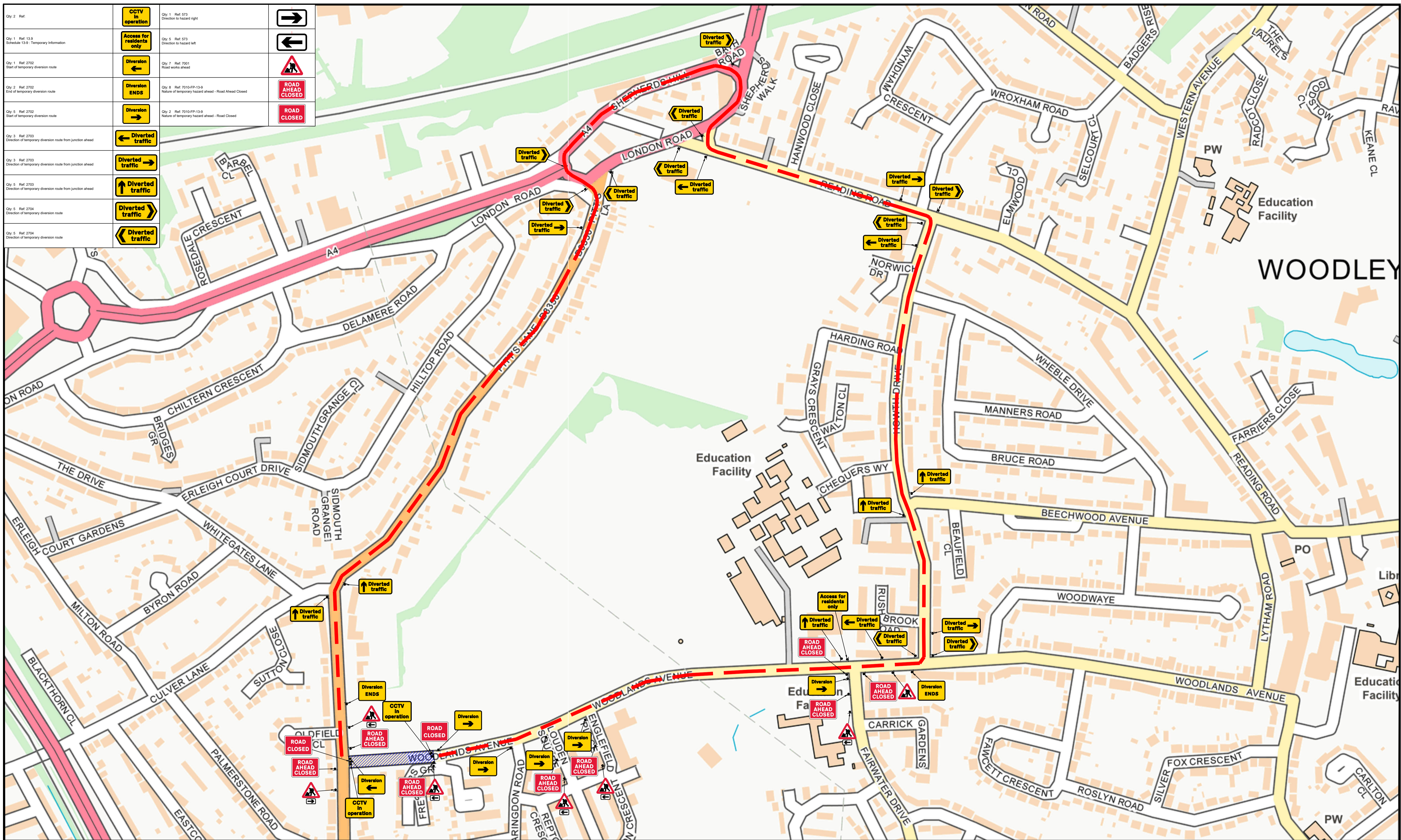

VolkerHighways

SAFETY ZONE DIMENSIONS

Permanent speed limit 30mph or less

Sideways safety zone 0.5m

Longways safety zone 0.5m

(Dimensions are minima)

Drawing Office			
DWG Number	VH9011		
Revision	0	Date Surveyed	12-11-25
Drawn By	PT	Date Drawn	12-11-25
Survey By	PT	Phase Number	5 of 10
Checked By	GT	Page Number	1 of 1

- Area of Works
- Safety Zones
- Temp Traffic Signals
- 750mm Road Signs
- 750mm/1m Road Cones
- Pedestrian Barrier

Site Details Address
Woodlands Avenue Reading RG5 3HJ Road Closure/Diversion

- | Drawing Notes |
|--|
| <ol style="list-style-type: none"> 1. Do not scale from this drawing, all dimensions to be verified on site. 2. It will be the responsibility of the contractor to ensure that all temporary traffic management shall be in accordance with the Traffic Signs Manual chapter 8 2009, Safety at Street works 2013, Traffic Signs Regulations and General Directions 2016 and all current / relevant Health and safety legislation. 3. All signage placement will be subject to available safe working space and all signage will be secured / ballasted with straps or sandbags. 4. A minimum lateral safety zone of 0.5m will be maintained at all times. 5. A minimum running lane of 3.0m will be maintained for buses and HGV's and a minimum of 2.5m for cars and light vehicles. 6. A safe segregated working area will be provided and maintained at all times. 7. Minimum size of temporary signage will be 750mm. 8. Aftack system to be utilised where practicable. 9. A minimum of 1.0m to be maintained for pedestrian access. |