



**WOKINGHAM**  
BOROUGH COUNCIL

**WBC 2023 No.04**

**ROAD TRAFFIC REGULATION ACT 1984  
&  
TRAFFIC MANAGEMENT ACT 2004**

**Wokingham Borough Council**

**(Goatley Way, Barkham Road, Broad Street, Station Road, Whitlock Avenue, Wellington Road, Milton Road, Bolton Drive, Fullbrook Avenue, Gipsy Lane, Murdock Road, Wokingham) (Prohibition of Turning, Prescribed Route, One-Way, Prohibition of Vehicles, Bus Lane, 7.5 Tonne Weight & 6' 6" Width Restriction) Order 2023**

Made on: **10<sup>th</sup> August 2023**

Coming into force on: **31<sup>st</sup> August 2023**

**Chris Easton,  
Assistant Director Place & Growth,  
Wokingham Borough Council,  
Shute End,  
Wokingham,  
RG40 1WL**

## **CONTENTS AND ARRANGEMENT OF ARTICLES**

### **PART I GENERAL**

- 1. Citation and commencement**
- 2. Interpretation**
- 3. – 6. Application of Order**

### **PART II**

- 7. – 8. ONE-WAY TRAFFIC**

### **PART III**

- 9. – 10. PROHIBITION OF TURNING & PRESCRIBED ROUTES**

### **PART IV**

- 11. – 14. PROHIBITION OF VEHICLES AT ANY TIME & BUS LANE  
TRAFFIC RESTRICTIONS**

### **PART V**

- 15. – 17. WEIGHT AND WIDTH RESTRICTIONS**

### **PART VI**

- 18. REVOCATION OF ORDERS**

### **SCHEDULES**

- 1 ONE-WAY TRAFFIC**
- 2 PROHIBITION OF TURNING**
- 3 PROHIBITION OF VEHICLES AT ANY TIME**
- 4 BUS LANE**
- 5 7.5 TONNE WEIGHT RESTRICTION**
- 6 6'6" WIDTH RESTRICTION**

**WOKINGHAM BOROUGH COUNCIL**, the Council as the Local Traffic Authority in exercise of its powers under Sections 1(1),1(2), 2(1),2(2),2(3), 4(1), 4(2), 19, 65(1) and 124 and Part IV of Schedule 9 to the Road Traffic Regulation Act 1984 as amended, (hereinafter referred to as 'the Act'), Part 6 of the Traffic Management Act 2004, and all other enabling powers, and after consultation with the Chief Officer of Police in accordance with Part III of Schedule 9 to the Act hereby **MAKES** the following Order:-

## **PART I GENERAL**

### **CITATION AND COMMENCEMENT**

1. This Order may be cited as the **Wokingham Borough Council (Goatley Way, Barkham Road, Broad Street, Station Road, Whitlock Avenue, Wellington Road, Milton Road, Bolton Drive, Fullbrook Avenue, Gipsy Lane, Murdoch Road, Wokingham) (Prohibition of Turning, Prescribed Route, One-Way, Prohibition of Vehicles, Bus Lane, 7.5 Tonne Weight & 6' 6" Width Restriction) Order 2023**

### **INTERPRETATION**

2. In this Order, except where the context otherwise requires, the following expressions have the meanings respectively assigned to them:-

"the Council" means the Wokingham Borough Council;

"Bus" has the same meaning as in Schedule 1 of the Traffic Signs Regulations and General Directions 2016;

"Bus Lane" has the same meaning as in Schedule 1 of the Traffic Signs Regulations and General Directions 2016;

"Bus-only route" means a traffic lane that may be used only by buses (or a particular description of bus) and some other class or classes of vehicular traffic as provided for in this Order and specified on a corresponding Plan;

"Emergency Services Vehicle" means a vehicle operated by the police, fire & rescue service or ambulance service;

"Goods Vehicle" has the same meaning as in the Traffic Signs Regulations and General Directions 2016;

"Maximum Gross Weight" has the same meaning as in the Traffic Signs and Regulations and General Directions 2016 and the maximum permissible laden weight of a motor vehicle is the gross weight indicated on the plate displayed on that motor vehicle as required by Regulation 70 and Schedule 10, Motor Vehicle (Construction and Use) Regulations 1986 (Ministry Plate) or in the event such a plate is not displayed the gross weight for Great Britain, displayed on the vehicle as required by Regulation 66 and Schedule 8, Motor Vehicle (Construction and Use) Regulations 1986.

"Pedal Cycle" has the same meaning as in Schedule 1 of the Traffic Signs Regulations and General Directions 2016; or that of an electrically assisted pedal cycle producing no more than 250 watts of power (continuously rated) and which cuts out at 15.5mph.

"Plan" means the plan or plans relating to those items contained in Schedules 1 to 5 which are attached and incorporated into this Order and shall be construed accordingly;

“Road” means the full width – including any footway or verge – of any length of highway or of any other road to which the public has access, and includes bridges over which a road passes;

“Vehicle” means a mechanically propelled or pedal powered form of transportation intended or adapted for use on the road.

3. Except where otherwise stated, any reference in this Order to a numbered Article or Schedule shall, unless the context otherwise requires, be construed as a reference to the Article or Schedule bearing that number in this Order and any reference to a Plan is a reference to a Plan incorporated into this Order.
4. The prohibitions and restrictions imposed by this Order shall be in addition to and not in derogation of any restriction, prohibition or requirement imposed by any Regulations or Orders made or having effect as if made under the Act of 1984, or by or under any other enactment.
5. Save where the contrary is indicated, any reference in this Order to: (a) this Order or another Order shall be construed as such a reference to this Order or, as the case may be, such other Order, as the same may have been or may from time to time be amended, varied or supplemented; (b) a Statute or Regulation shall be construed as reference to such Statute or Regulations as the same may have been, or may from time to time be amended or re-enacted.
6. Nothing in Articles 8, 9, 10 or 17 shall apply to any vehicle on an occasion when it is being used for Fire Brigade, Ambulance or Police purposes (in the event of an emergency), if the observance of that provision would be likely to hinder the use of that vehicle for the purpose for which it is being used on that occasion, or a vehicle in the service of the local authority in the course of road cleansing or gully emptying.
7. The Interpretation Act 1978 shall apply to the interpretation of this Order as it applies to the interpretation of an Act of Parliament and as if for the purposes of section 21 of that Act this Order were an Act of Parliament and the Orders revoked by this Order were Acts of Parliament thereby repealed.

## **PART II**

### **ONE-WAY TRAFFIC**

8. Save as provided in Article 6, no person shall cause or permit any vehicle to proceed in the length of road specified in column 1 of Schedule 1 to this Order other than in the direction specified in column 2 of that Schedule and specified on the corresponding plan for the said road.

## **PART III**

### **PROHIBITION OF TURNING & PRESCRIBED ROUTES**

#### **PROHIBITION OF TURNING**

9. Save as provided in Article 6, no person shall except upon the direction of or with the permission of a police constable in uniform, drive or cause or permit to be driven any vehicle proceeding in any of the lengths of road specified in column 1 of Schedule 2 to this Order to make a turn as specified on to the road specified in Column 2 of the said Schedule and specified on the corresponding plan for the said road.

## **PRESCRIBED ROUTE**

10. Save as provided in Article 6, every person causing any vehicle to proceed in a northwards direction in Wellington Road shall, on reaching the junction with Barkham Road / Station Road, Wokingham cause that vehicle to proceed in an Ahead Only direction onto Station Approach as specified on the corresponding plan for the said road.

## **PART IV PROHIBITION OF VEHICLES & BUS LANE TRAFFIC RESTRICTIONS**

### **PROHIBITION OF VEHICLES**

11. Save as provided in Article 13, no person shall cause a vehicle to enter the length of road specified in columns 1 and 2 of Schedule 3 to this Order and specified on the corresponding plan for the said road, unless that vehicle is proceeding in the direction specified in column 3 of that item and is of a type specified in column 4 of that item.

### **BUS LANE TRAFFIC RESTRICTIONS**

12. Save as provided in Article 6, no person shall use a vehicle or cause or permit any vehicle to be in any of the lengths of bus lane specified in columns 1 and 2 of Schedule 4 to this Order and specified on the corresponding plan for the said road, unless that vehicle is proceeding in the direction specified in column 3 of that item and is of a type specified in column 4 of that item.
13. Nothing in Articles 11 or 12 shall prevent any person causing or permitting any vehicle to be in the length of road specified in Schedule 3 to this Order or to be in any of the lengths of bus lane specified in Schedule 4 to this Order and in the direction specified, insofar as it is absolutely necessary, to enable the vehicle to be used for any of the purposes set out hereunder, or to wait in the bus lane for so long as may be necessary for any of those purposes:-
  - (a) the removal of any obstruction or vehicle to effect emergency repairs to a vehicle in the bus lane so as to relieve any obstruction.
  - (b) Police, Fire Brigade, Ambulance or Civil Defence purposes;
  - (c) the service of any local authority or water authority in pursuance of statutory powers or duties; or in connection with the supply of gas, electricity or oil, or any telecommunications system as defined in the Telecommunications Act 1984.
  - (d) to be used in connection with the maintenance, improvement or reconstruction of any length of road, or the laying, erection, alteration or repair in or near any of the lengths of road of any sewer or main, pipe or apparatus for the supply of gas, water, electricity, oil or telegraph line in the length of road or bus lane; or
  - (e) the placing, maintenance or removal of any traffic sign.
14. Nothing in Article 12 shall prevent any person causing or permitting any vehicle to be in a bus lane if the vehicle enters the bus lane in order to prevent an accident and the vehicle then leaves the bus lane as soon as it is practicable.

**PART V**  
**WEIGHT AND WIDTH RESTRICTIONS**

**7.5 TONNE WEIGHT RESTRICTION**

15. Save as provided in Article 16 of this Order, no person shall, except upon the direction or with the permission of a Police Constable in uniform, cause or permit any heavy commercial vehicle in excess of 7.5 tonnes maximum gross weight to proceed along the length of road specified in Schedule 5 to this Order and specified on the corresponding plan for the said road.
16. Nothing in Article 15 of this Order shall make it unlawful for any person to cause or permit a heavy commercial vehicle to proceed along the length of road specified in the Schedule 5 to this Order (hereinafter referred to as "the road") if the said vehicle is being used:-
- (a) for or in connection with the conveyance of persons, goods or merchandise to or from any premises situated on or adjacent to the length of road;
  - (b) for such purpose in any other road, to be used in connection with any of the following operations, namely:-
    - (i) building, industrial or demolition operations;
    - (ii) the removal of any obstruction to traffic;
    - (iii) to be used in connection with the maintenance, improvement or reconstruction of any length of road, or the placing, maintenance or removal of any traffic sign;
    - (iv) the laying, erection, alteration or repair in or near any of the lengths of road of any sewer or main, pipe or apparatus for the supply of gas, water, electricity, oil or telegraph line or in connection with the supply of gas, electricity or oil, or any telecommunications system as defined in the Telecommunications Act 1984;
  - (c) the service of any local authority or water authority in pursuance of statutory powers or duties;
  - (d) the vehicle of a universal service provider (as defined in Section 4(3) and (4) of the Postal Services Act 2000) to be used for the purposes of delivering and/or collecting mail; or
  - (e) Police, Fire Brigade, Ambulance or Civil Defence purposes; or
  - (f) a vehicle to wait as long as it may be necessary to enable it to be used in the provision of a local service within the meaning of the Transport Act 1985;

**6'6" (2.0M) WIDTH RESTRICTION**

17. Save as provided in Article 6 of this Order, no person shall, except upon the direction or with the permission of a Police Constable in uniform, cause or permit any vehicle the width of which exceeds six feet six inches (6'6") (2.0m) to proceed in the length of road specified in Schedule 6.

## **PART VI REVOCATION**

### **ORDERS OR PARTS OF ORDERS TO BE REVOKED**

18. The following Orders or parts of Orders are hereby revoked:-
- (a) Royal County of Berkshire (Wokingham) (Prohibition of Vehicles) Order 1967 in its entirety
  - (b) Royal County of Berkshire (Murdoch Road, Wokingham) (Traffic Regulation) Order 1987 in its entirety.
  - (c) The Wokingham District Council (Prohibition of Driving, No Waiting At Any Time, No Loading or Unloading, Disabled Parking and One Way Traffic) Order 2004 in its entirety.

### **SCHEDULE 1 ONE-WAY TRAFFIC**

#### **Roads in the Borough of Wokingham**

<b>Column 1</b>	<b>Column 2</b>
1. Goatley Way	From its junction with Peach Street, in a south-eastwards and south-westwards direction for its entire length.

### **SCHEDULE 2 PROHIBITION OF TURNING**

#### **Roads in the Borough of Wokingham**

<b>Column 1</b>	<b>Column 2</b>
1. Barkham Road	No Right Turn on to Oxford Road
2. Broad Street	No Right Turn on to Rose Street
3. Station Road	No Right Turn on to Station Approach
4. Whitlock Avenue	No Right Turn on to A329 London Road

### **SCHEDULE 3 PROHIBITION OF VEHICLES AT ANY TIME**

#### **Roads in the Borough of Wokingham**

<b>Column 1</b>	<b>Column 2</b>	<b>Column 3</b>	<b>Column 4</b>
1. Milton Road	From a point approximately 2 metres south of the boundary between Nos.4 / 2 Milton Road, southwards for a distance of approximately 4.8 metres.	Southbound	Bus or Emergency Services Vehicle
1. Bolton Drive	From a point approximately 75 metres southwest of the extended west kerbline of Martyn Crescent, south-westwards for a distance of approximately 283 metres.	Eastbound and Westbound	Bus, Emergency Services Vehicle or

			Pedal Cycle
--	--	--	----------------

#### SCHEDULE 4 BUS LANE

##### Roads in the Borough of Wokingham

Column 1	Column 2	Column 3	Column 4
1. Fullbrook Avenue  Bolton Drive	From a point approximately 45 metres northeast of a point opposite of the extended east kerbline of Bays Crescent eastwards for a distance of approximately 14 metres.	Eastbound	Bus, Emergency Services Vehicle or Pedal Cycle
2. Fullbrook Avenue  Bolton Drive	From a point approximately 59 metres northeast of the extended east kerbline of Bays Crescent, westwards for a distance of approximately 19 metres.	Westbound	Bus, Emergency Services Vehicle or Pedal Cycle

#### SCHEDULE 5 7.5 TONNE WEIGHT RESTRICTION

##### Roads in the Borough of Wokingham

Item No.	Length of Road
1. Gipsy Lane	From its junction with Langborough Road, for its entire length.

#### SCHEDULE 6 6'6" (2.0M) WIDTH RESTRICTION

##### Roads in the Borough of Wokingham

Item No.	Length of Road
1. Murdoch Road	From a point approximately 8 metres west of its junction with South Drive / Crescent Road, westwards for a distance of approximately 23 metres.

THE COMMON SEAL of the )  
WOKINGHAM BOROUGH COUNCIL )  
was hereunto affixed on )  
the **10<sup>th</sup> August 2023** )  
in the presence of:- )

*E. Taylor*

Legal Assistant

**Authorised Signatory/ Solicitor**



36151



## ORDER MAPS

### SCHEDULE 1- GOATLEY WAY-ONE WAY TRAFFIC

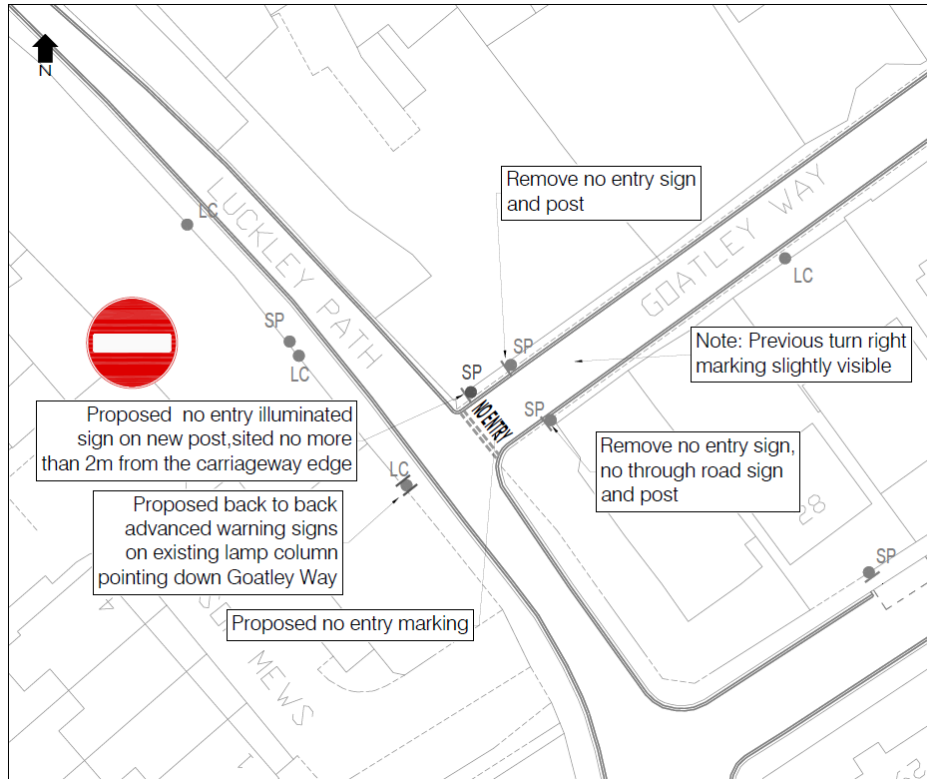

36151

*E. Taylor*

Proposed advanced warning sign on existing lamp column for both no right turns

Proposed illuminated no right turn sign on new post

Remove existing faded no right turn sign and post

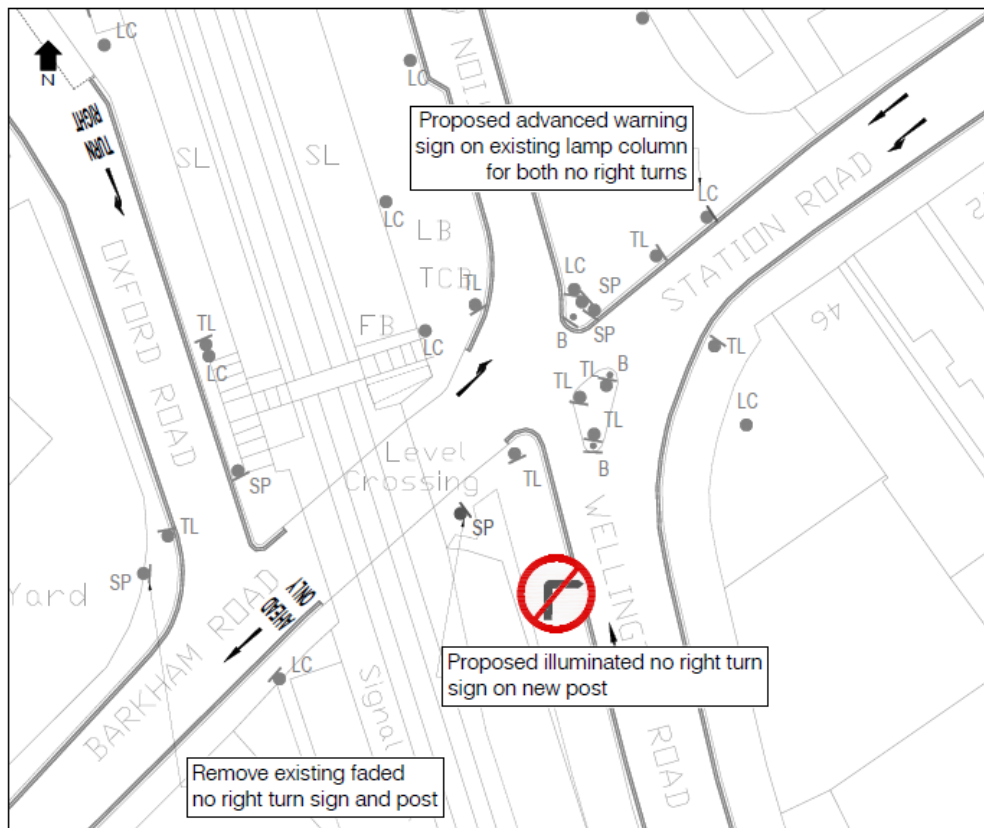

*E. Taylor*

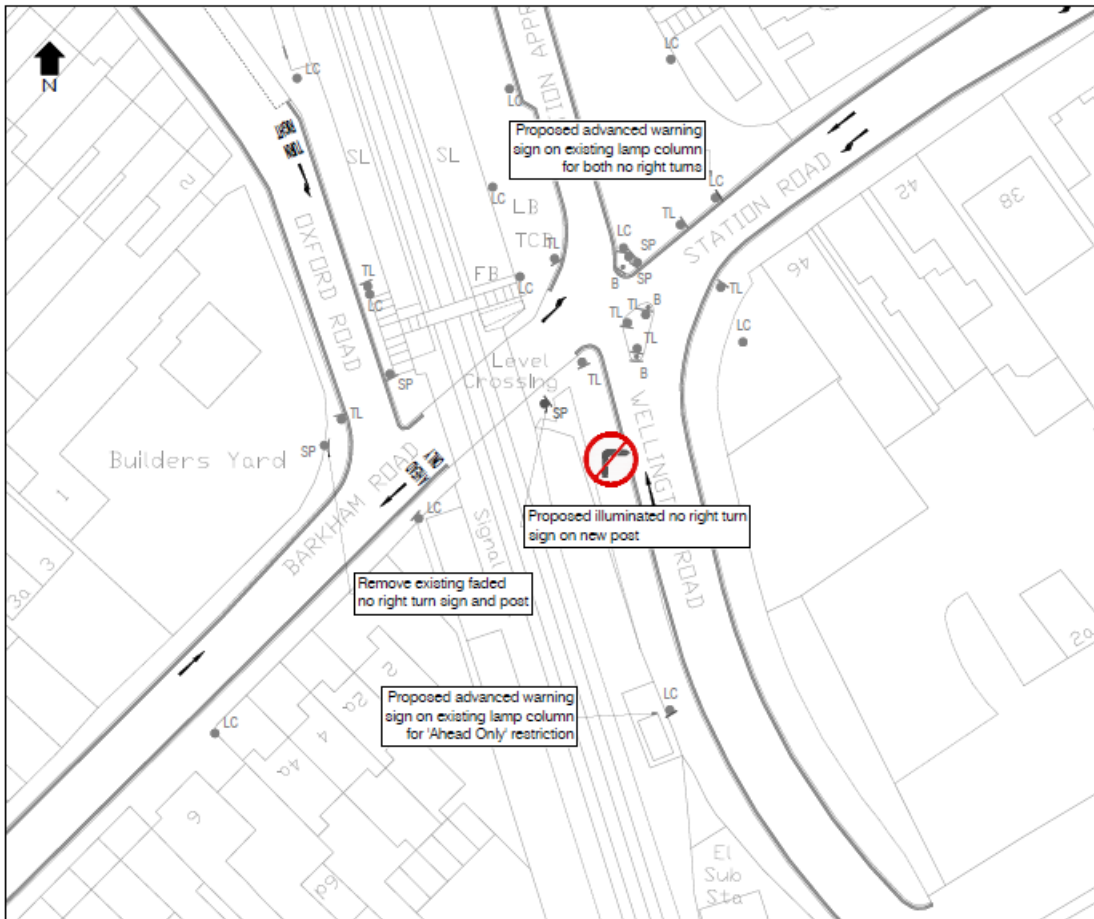

36151



## BROAD STREET-BANNED RIGHT TURN

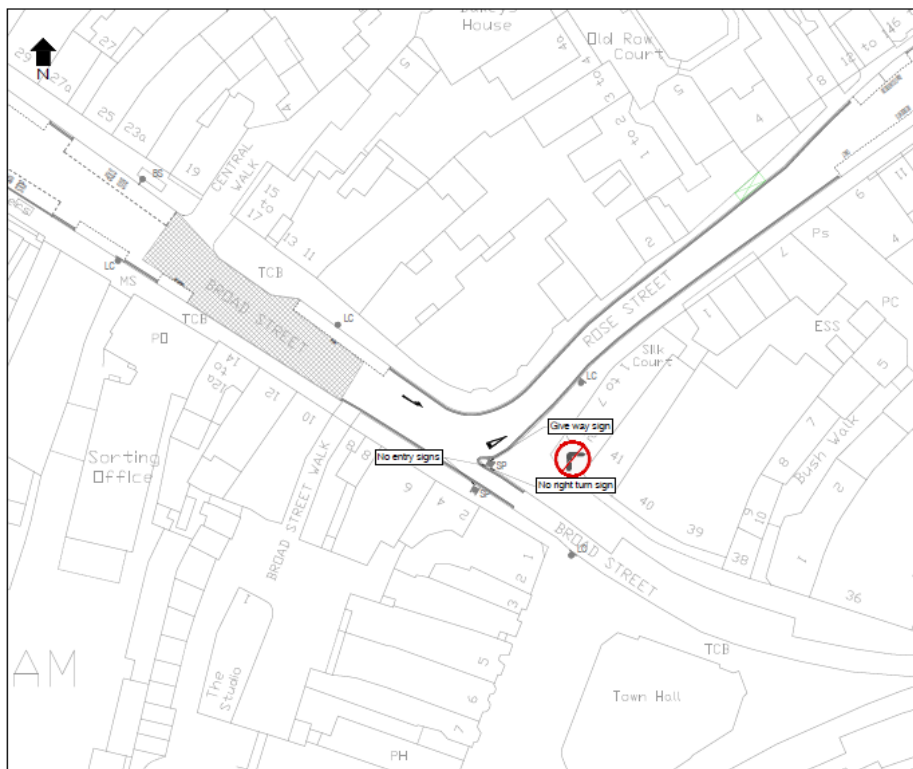

*E. Taylor*

## WHITLOCK AVENUE-BANNED RIGHT TURN

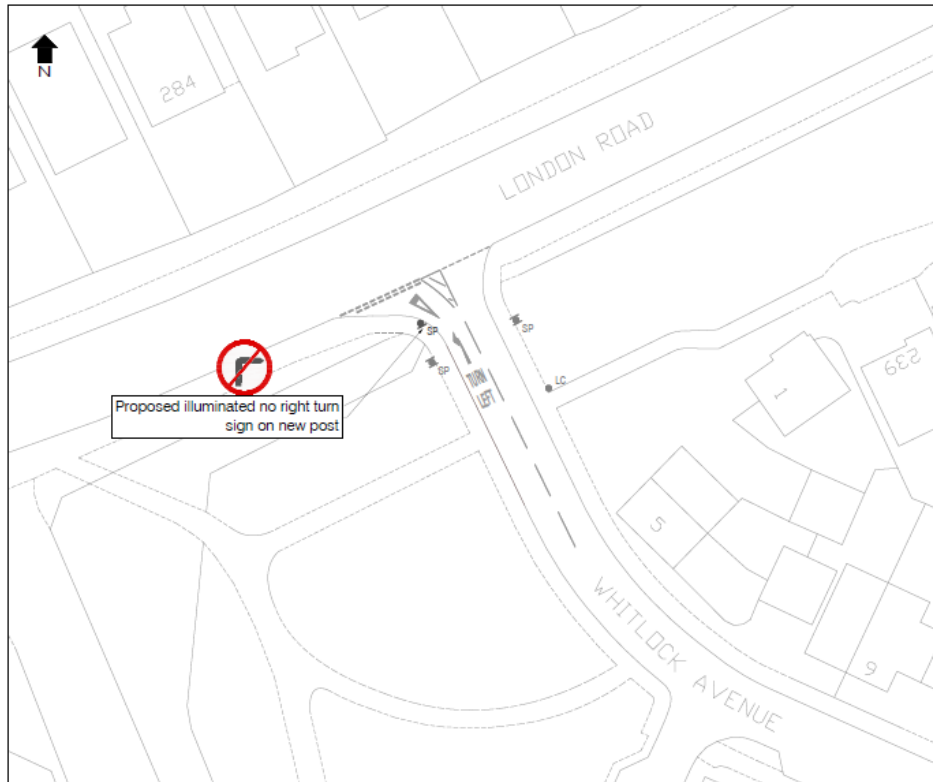

36151



## SCHEDULE 3-MILTON ROAD AND BOLTON DRIVE-PROHIBITION OF VEHICLES

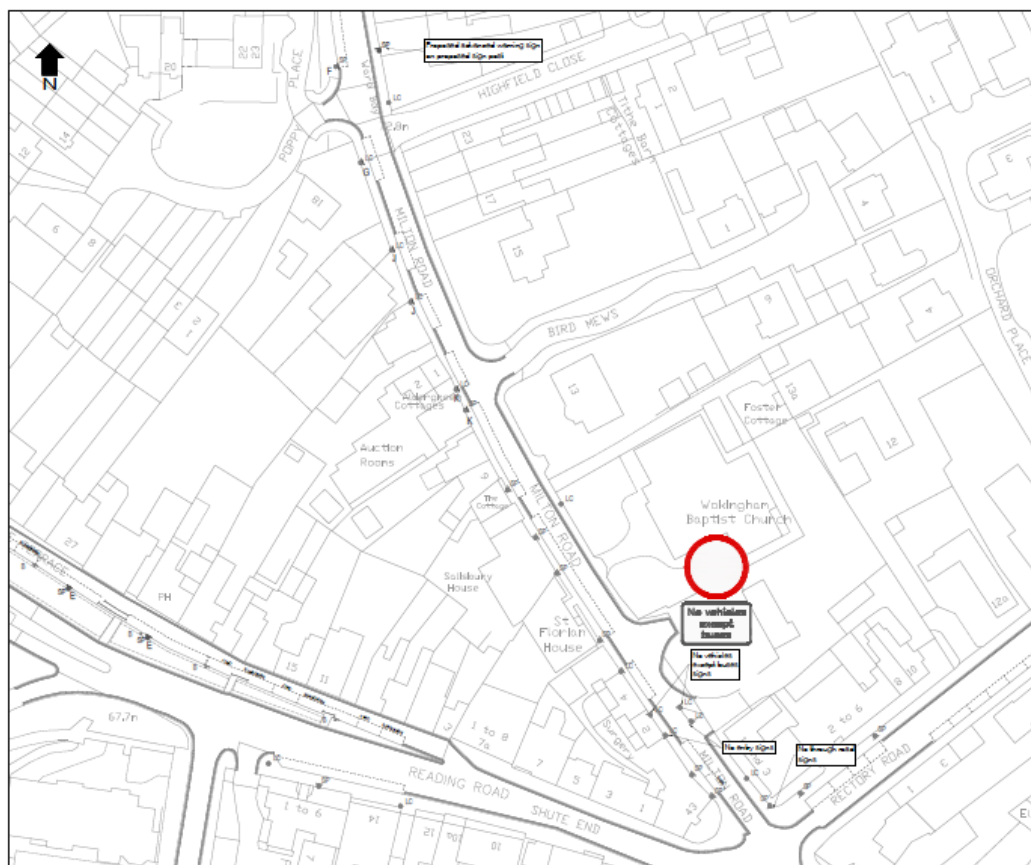

*E. Taylor*

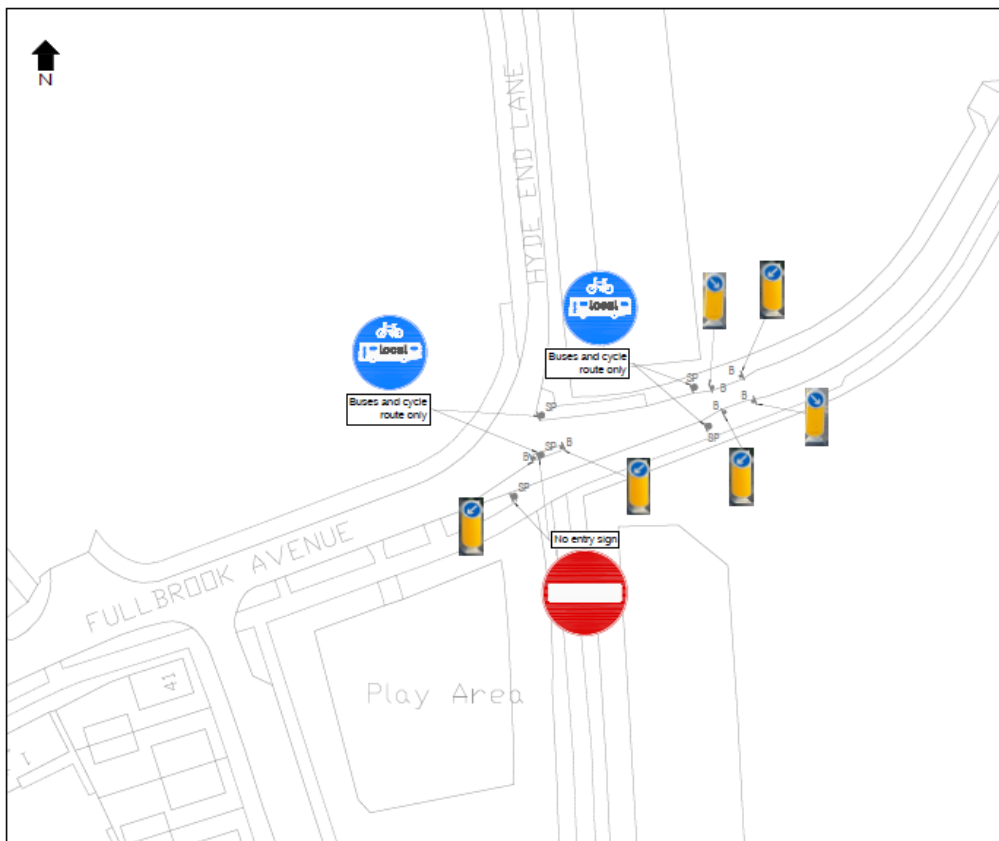

**SCHEDULE 4-FULLBROOK AVENUE AND BOLTON DRIVE-BUS LANE AND NO ENTRY**

36151

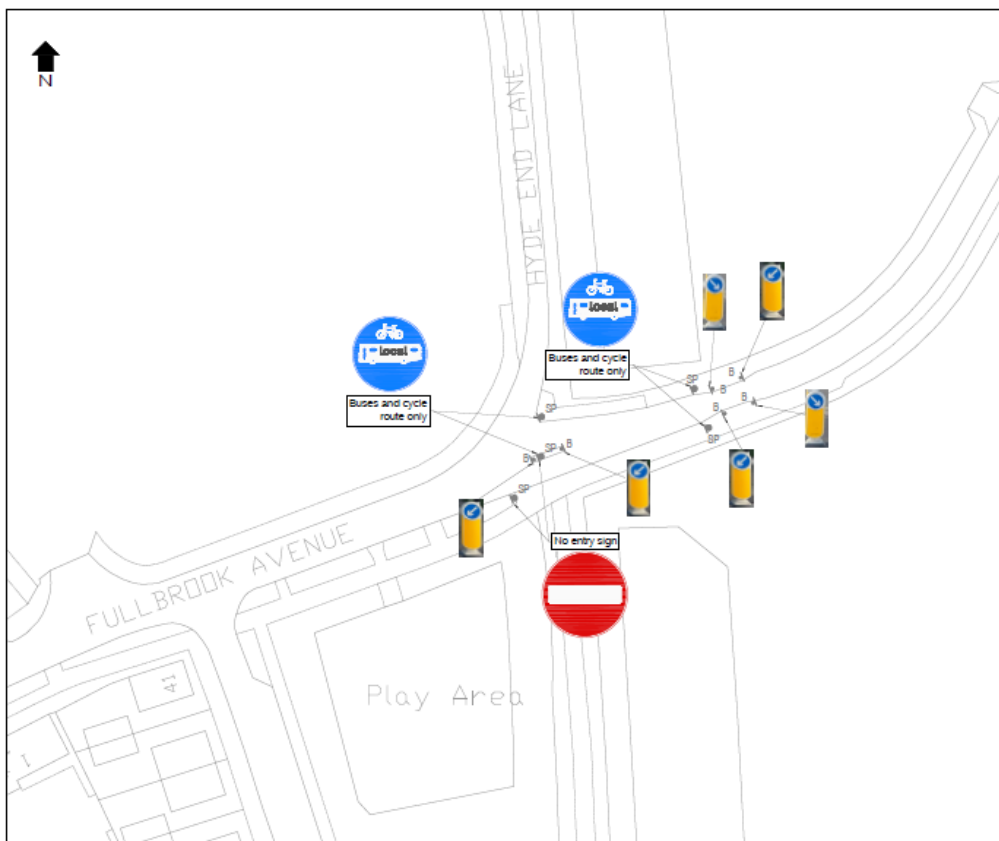

*E. Taylor*

## SCHEDULE 5- GIPSY LANE-WEIGHT LIMIT

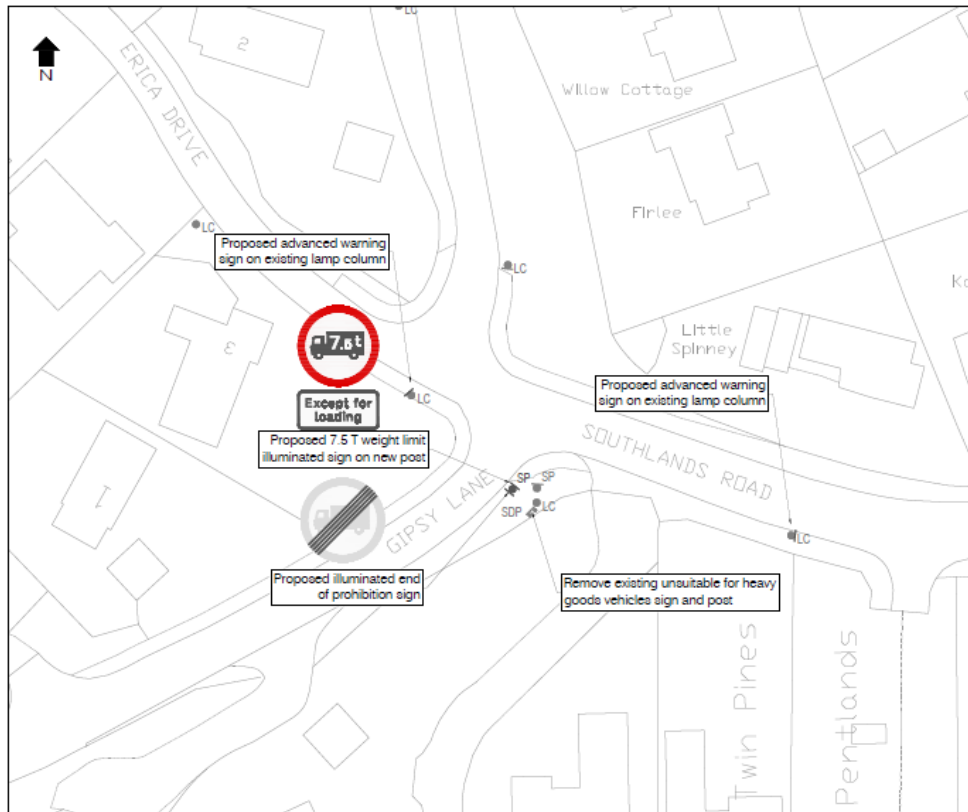

36151

*E. Taylor*

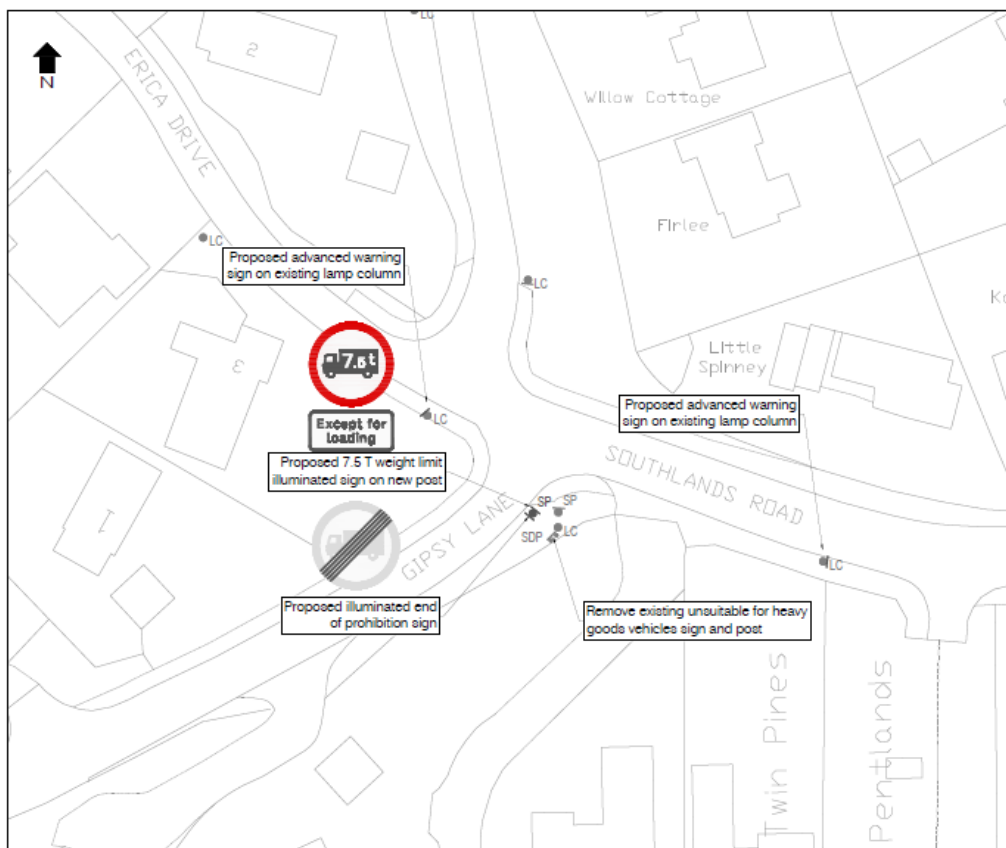

## SCHEDULE 6-MURDOCH ROAD- WIDTH LIMIT

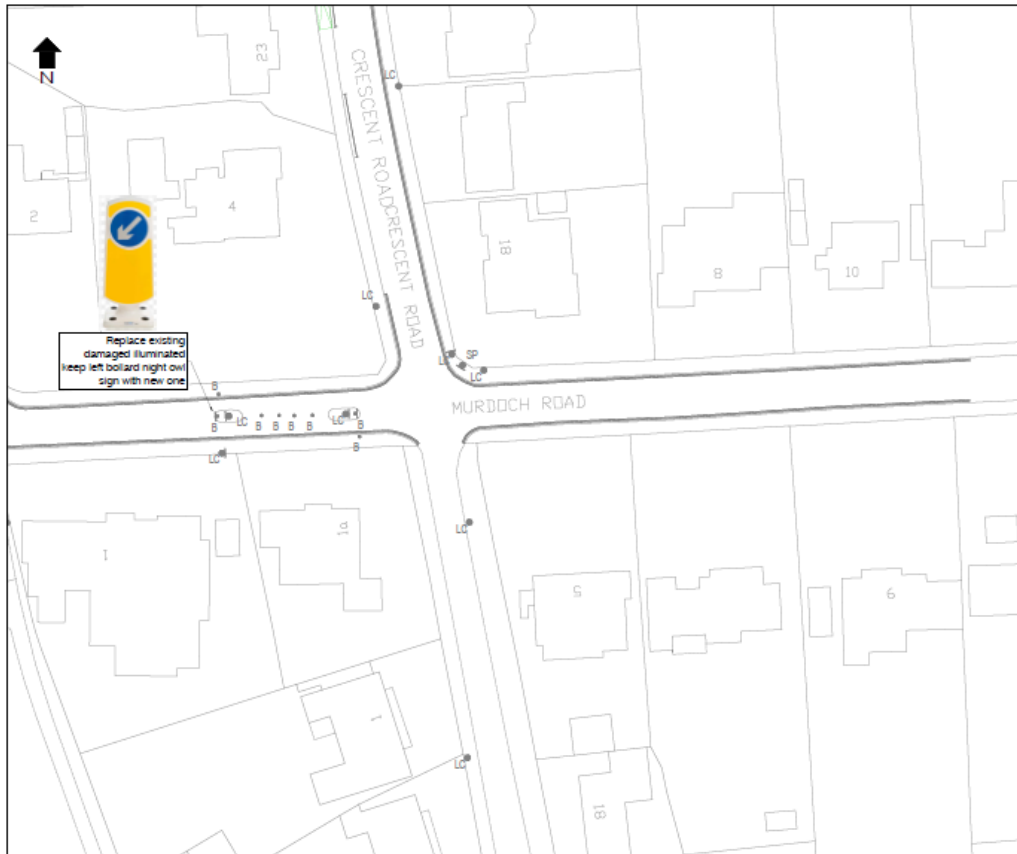

36151

*E. Taylor*





**Wokingham Borough Council**

**(Goatley Way, Barkham Road, Broad Street, Station Road, Whitlock Avenue, Wellington Road, Milton Road, Bolton Drive, Fullbrook Avenue, Bolton Drive, Gipsy Land, Wokingham) (Prohibition of Turning, Prescribed Route, One-Way, Prohibition of Vehicles, Bus Lane, 7.5 Tonne Weight & 6' 6" Width Restriction)  
Order 2023**

**STATEMENT OF REASONS**

Wokingham Borough Council has made the above-named order, which seeks to revoke The Royal County of Berkshire (Wokingham) (Prohibition of Vehicles) Order 1967, The Royal County of Berkshire (Murdoch Road, Wokingham) (Traffic Regulation) Order 1987 and The Wokingham District Council (Prohibition of Driving, No Waiting At Any Time, No Loading or Unloading, Disabled Parking and One



Way Traffic) Order 2004 and to formalise the following restrictions on traffic movements along the routes specified.

**ONE-WAY TRAFFIC:** No person shall drive or cause or permit to be driven any vehicle to proceed along Goatley Way from its junction with Peach Street other than in a south-eastwards and south-westwards direction for its entire length.

**PROHIBITION OF RIGHT TURNS:** No person shall drive or cause or permit to be driven any vehicle from Barkham Road to turn right onto Oxford Road; from Broad Street to turn right onto Rose Street; from Station Road to turn right onto Station Approach; from Whitlock Avenue to right turn onto A329 London Road.

**PRESCRIBED ROUTE:** No person shall drive or cause or permit to be driven any vehicle along Wellington Road when proceeding northwards on reaching the junction with Barkham Road / Station Road, Wokingham or drive or cause or permit any vehicle to proceed other than in an Ahead Only direction onto Station Approach.

**PROHIBITION OF VEHICLES AT ANY TIME:** No person shall drive or cause or permit to be driven a vehicle along Milton Road from approximately 2 metres south of property numbers 4 / 2 Milton Road, southwards for approximately 4.8 metres, unless that vehicle is proceeding southbound nor to enter Bolton Drive from approximately 75 metres southwest of Martyn Crescent, south-westwards for approximately 283 metres with exemption for pedal cycles unless that vehicle is proceeding eastbound or westbound.

**BUS LANE:** No person shall drive or cause or permit to be driven a vehicle along Fullbrook Avenue / Bolton Drive from approximately 45 metres northeast of Bays Crescent eastwards for approximately 14 metres nor along Fullbrook Avenue / Bolton Drive from approximately 59 metres northeast of Bays Crescent, westwards for approximately 19 metres. Pedal cycles are exempted from this restriction.

**7.5 TONNE WEIGHT RESTRICTION:** No person shall drive or cause or permit to be driven a vehicle with a weight of over 7.5tonne along Gipsy Lane from Langborough Road, for its entire length.

**WIDTH RESTRICTION:** No person shall drive or cause or permit to be driven a vehicle with a width of over 2metres, from a point approximately 8 metres west of its junction with South Drive / Crescent Road, westwards for a distance of approximately 23 metres.

The proposals have been drawn to improve traffic movements at these locations and to ensure that the existing schemes comply with current standards so that they can be enforced.

The proposed restrictions are considered by the Council to be necessary and expedient to avoid danger to persons or other traffic using these roads or prevent the likelihood of such danger arising and to facilitate the passage of traffic. The proposed measures have been subject to consultations with local councillors representing the areas and the Police.

**Chris Easton,  
Assistant Director Place & Growth,  
Wokingham Borough Council,  
Shute End,  
Wokingham,  
RG40 1WL**